

STPR-MOD-KIT

Models: PIER-36TRB-IFT, ST-36TRB-IFT, ST-DV36IN, PIER-DV36IN, GDFL4136IFT, GDST4336IFT
Installation Instructions



Leave this manual with party responsible for use and operation.

DANGER



**HOT GLASS WILL
CAUSE BURNS.**

**DO NOT TOUCH GLASS
UNTIL COOLED.**

**NEVER ALLOW CHILDREN
TO TOUCH GLASS.**

A barrier designed to reduce the risk of burns from the hot viewing glass is provided with this appliance and must be installed for the protection of children and other at-risk individuals.

Note: The control module **MUST** be set to 30% turndown when the STPR-MOD-KIT kit is installed.

Note: If an optional LINER-36ST or LINER-36PIER kit will be used with the STPR-MOD-KIT, the LINER-36ST/ LINER-36PIER instructions will be needed during installation of the STPR-MOD-KIT.

Note: The STPR-MOD-KIT is not compatible with fiber refractory.

BTU Specifications

Models <i>(U.S. or Canada)</i>		Maximum Input BTU/h	Minimum Input BTU/h	Orifice Size (DMS)
STPR-MOD-KIT (NG)	<i>(0-2000 FT)</i>	38,000	26,000	32
STPR-MOD-KIT (PROPANE)	<i>(0-2000 FT)</i>	29,000	19,000	52

CAUTION! Do not install damaged components.

WARNING! Risk of Injury! This kit must be installed by a qualified service technician.

WARNING! Choking Hazard! Keep media and stones out of reach of children.

CAUTION! Risk of Cuts, Abrasions or Flying Debris. Wear protective gloves and safety glasses during installation. Sheet metal edges are sharp.

TOOLS

Screw gun equipped with 1/4 in. socket or
1/4 in. wrench
3/8 in. wrench (Propane Appliances Only)
Instructions for optional glass kit, if applicable.

Preparation

CAUTION! Risk of Burns! The fireplace should be turned off and cooled before contemporary kit is installed.

- Remove the STPR-MOD-KIT burner assembly from the base pan assembly by removing four screws.
- Shut off gas supply and disconnect electrical power.
- Remove decorative fronts, glass assemblies, lava rock, embers and logs, if previously installed.

KIT COMPONENTS (Shown in Figure 1)

- (1) Basepan Assembly
- (1) Burner Assembly
- (1) Pilot Shield/Rock Stop Jig Assembly
- (2) Side Vanity Shrouds
- (2) Refractory Channels
- (1) Pilot Bracket
- (1) End Vanity Shroud
- (PIER36TRB-IFT, PIER-DV36IN, GDFL4136IFT Only)
- (1) Propane Orifice
- (10) 1/2 Inch Self-Drilling Screws
- (1) Bag 1/2 inch screws (25 screws per bag)
- (1) Propane Conversion Plate
- (2) Burner Mesh

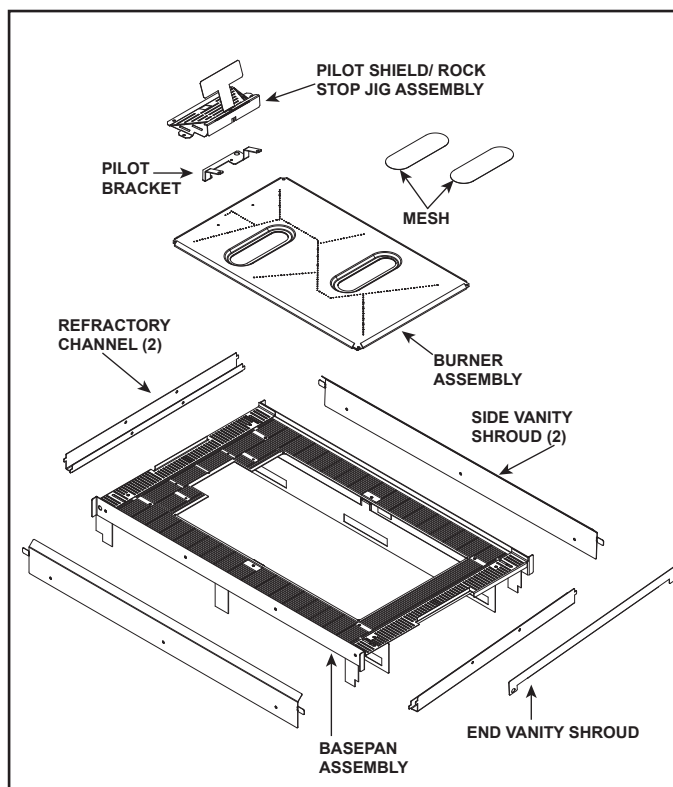

Figure 1. Contemporary Kit Metal Components

Installation Instructions

1. Remove pilot shield by removing the two screws that secure the shield to the base pan.
2. Remove the two screws that secure the pilot to the pilot support.
3. Remove metal refractory. See Figure 2.
ST-36TRB-IFT, ST-DV36IN, GDST4336IFT = 4 screws (2 panels)
PIER36TRB-IFT, PIER-DV36IN, GDFL4136IFT= 2 screws (1 panel)
4. Remove the four screws that attach the burner brackets to the basepan, then remove the burner by sliding it away from the pilot and lifting it out of the base pan. See Figure 3.



Figure 2. Remove Metal Refractory

- Remove base pan by removing one screw and lifting it out of the firebox. See Figure 3 for screw location.



Figure 3. Remove Base Pan

- Remove the two air skirts by removing four screws as shown in Figure 4. The four screws MUST be reinstalled to fill the holes.

WARNING! Risk of Asphyxiation! DO NOT leave holes open! Screws from air skirt removal MUST be reinstalled in same holes as removed to maintain firebox seal.



Figure 4. Remove Air Skirts

Note: Propane (P) Appliances Only

The appliance MUST be derated. If converting the appliance to propane (P), refer to the propane conversion instructions and use the #52 orifice that is included in this Contemporary (STPR-MOD-KIT) kit. If the appliance is already propane, replace the current orifice with the #52 orifice provided in this Contemporary (STPR-MOD-KIT) kit. Fill out the conversion plate included with this kit and replace the conversion plate already on the appliance. It should be located in the control cavity, next to the rating plate.

- Install refractory channels as shown in Figure 1, using two self-tapping screws for each channel.

Place pilot side refractory channel into position by setting onto the tab and installing the two self-drilling screws. See Figure 5. PIER36TRB-IFT, PIER-DV36IN, and GDFL4136IFT models will only use one refractory channel, which will be installed on the pilot side of the appliance.

ST-36TRB-IFT, ST-DV36IN, and GDST4336IFT Only: Install refractory channel on the side opposite the pilot by positioning the channel against the firebox wall below the firebox ledges. Slide the channel up until the tabs on the channel contact the firebox ledges on both sides. See Figure 6. Hold in place while fastening with two self-drilling screws.

Note: If the optional LINER-36ST or LINER-36PIER kit will be used with the STPR-MOD-KIT, install the refractory supports and glass panels that are included in the kit using the instructions included with the kit.

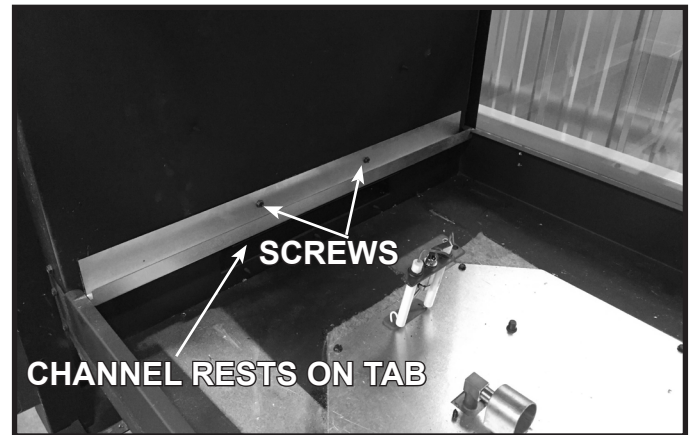

Figure 5. Install Refractory Channel - Pilot Side



Figure 6. Install Refractory Channel - Side Opposite the Pilot

8. The two tabs on the bottom of the metal refractory must be bent upward behind the panel or broken off in order for the refractory to fit in the refractory channel. See Figure 7.
9. Reinstall metal refractory by setting the bottom edge into the refractory channel and using the screws that were removed in Step 3. Each refractory panel requires two screws for installation. See Figure 8.

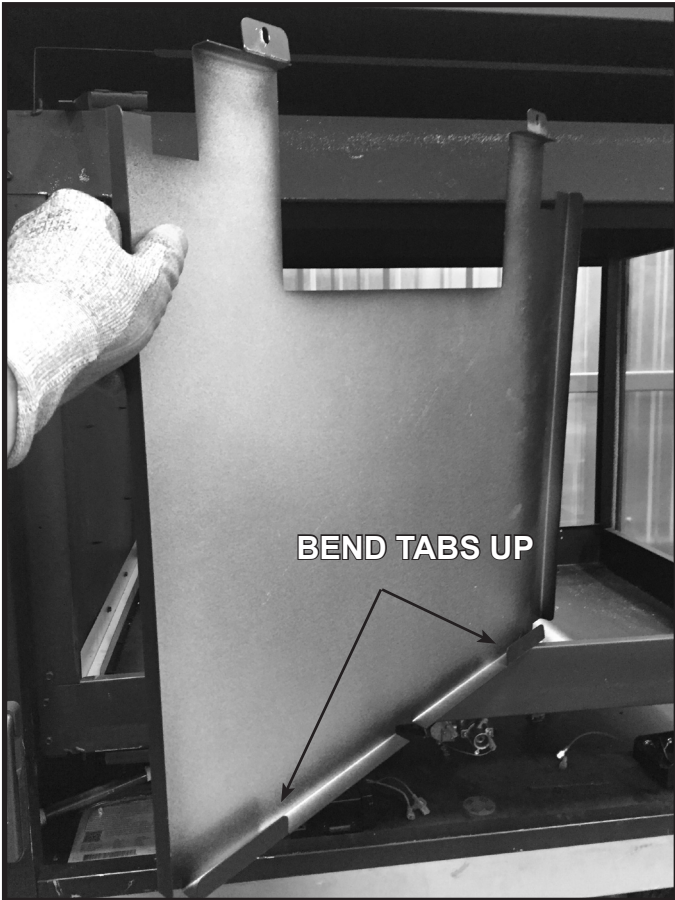

Figure 7. Reinstall Refractory Panels - Tabs Bent Up

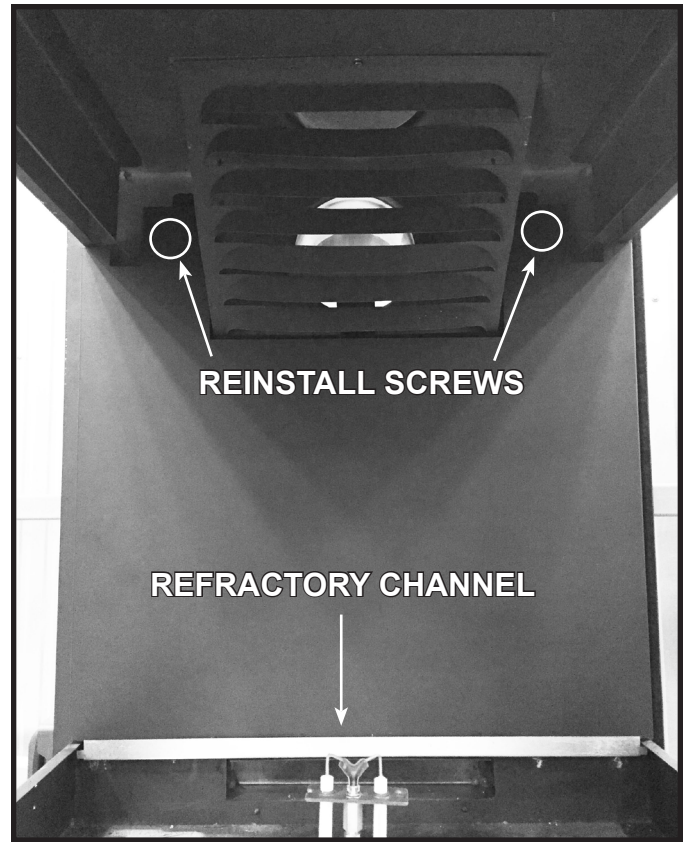

Figure 8. Reinstall Refractory Panels - Install Screws

10. Set the contemporary base pan assembly into the appliance firebox. The base pan assembly must be positioned flush against the metal refractory or glass panel on the pilot end of the firebox. This will ensure the burner neck can fully engage on the orifice. See Figure 9.

WARNING! Risk of Explosion! Base pan *MUST* be positioned correctly to allow for full engagement of the burner neck.

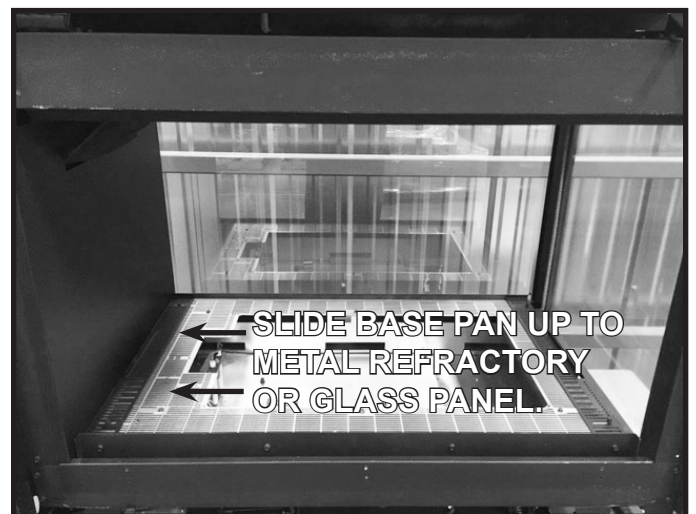

Figure 9. Install Base Pan

11. Slide air shutter toward the pilot, into the closed position.
12. To install the burner assembly, lower the burner into the base pan, then slide the burner neck through the shutter and onto the orifice. The burner neck is accessible through the oval in the burner to ease alignment with the shutter and orifice. Due to the tight fit of the burner, it may be necessary to push up on the orifice bulk head from under the firebox to align the orifice and shutter with the burner neck. See Figure 10 and Figure 11. Ensure that the burner neck is fully engaged on the orifice. Attach the burner to the base pan using 4 screws. See Figure 12. Place the two oval-shaped mesh pieces over the openings as shown in Figure 12.

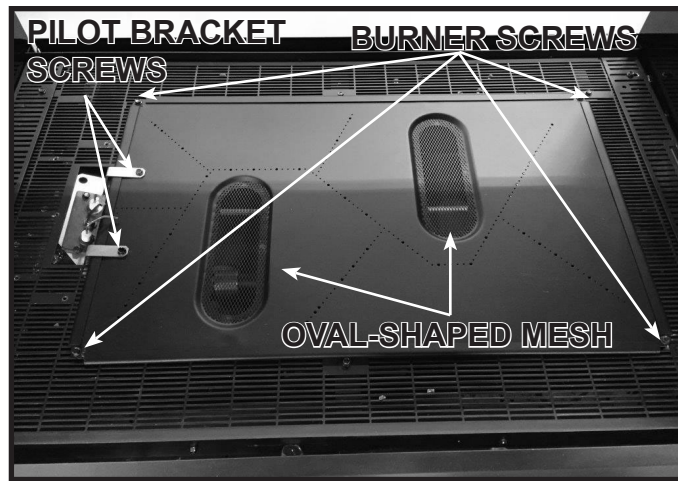

Figure 12. Oval-Shaped Mesh in Place

13. Slide the pilot bracket under the pilot as shown in Figure 13. Attach it to the burner using two screws. Attach the pilot to the pilot bracket using two screws.



Figure 10. Align Orifice and Burner Neck

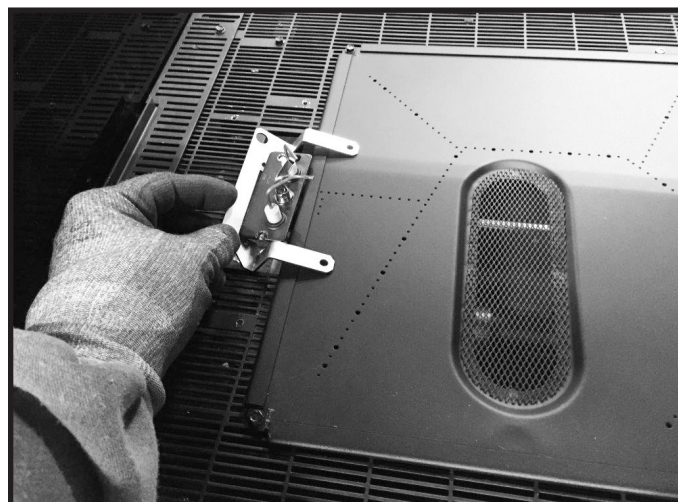

Figure 13. Install Pilot Bracket

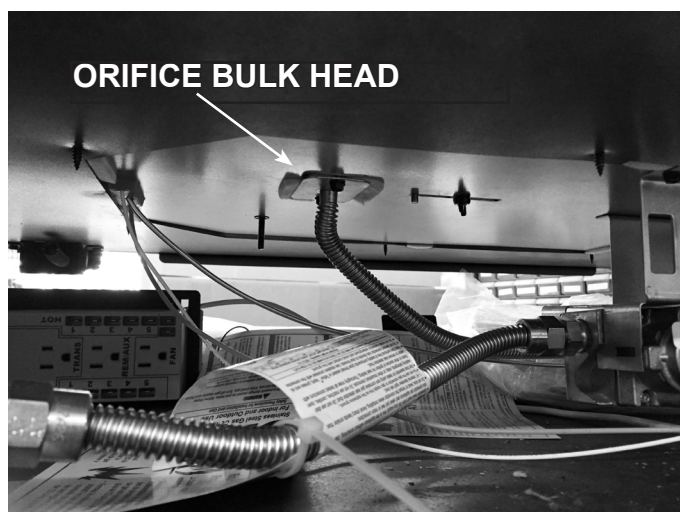

Figure 11. Orifice Bulk Head Location

14. **PIER36TRB-IFT, PIER-DV36IN, and GDFL4136IFT**
Only: Install the end vanity shroud opposite the pilot. Set the shroud in place as shown in Figure 14 and Figure 15. No screws are used.



Figure 14. Install End Vanity Shroud



Figure 15. End Vanity Shroud in Place

15. With the burner neck fully engaged on the orifice, loosen the two screws securing the adjustable base pan ledge on the opposite end of the pilot. Slide the ledge out until it contacts either the metal refractory, glass panel, or the end vanity shroud (PIER36TRB-IFT, PIER-DV36IN, and GDFL4136IFT) on the opposite side of the pilot. Tighten screws to secure the adjustable ledge in place. This will prevent the media from falling off the base pan. See Figure 16.

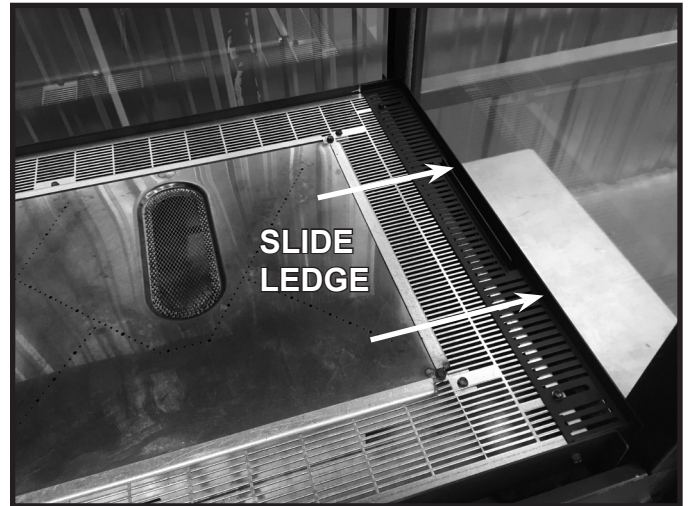

Figure 16. Secure the Adjustable Ledge

16. Attach the pilot shield/rock stop assembly using 4 screws. Install the two screws farthest from the burner first. Then bend the two tabs downward until the screw holes line up, and install the other two screws. Bend rock stop up as shown in Figure 17.



Figure 17. Bend Rock Stop Up and Tab Down

Install Glass Media

WARNING! Risk of Explosion! DO NOT place media on pilot assembly. Delayed ignition could occur. Use media jig for proper media placement.

17. A media kit is required for use with the STPR-MOD-KIT. Install the media according to the instructions included with the kit.
18. Locate the side vanity shrouds. Bend the tabs 90 degrees in the same direction as the 45 degree bends. Place the shroud by resting the tabs on the firebox ledge. Center the shroud and attach using three self-drilling screws. Repeat on the opposite side. See Figure 18 and Figure 19.



Figure 18. Side Vanity Shroud



Figure 19. Side Vanity Shroud Installed

Optional Stones Kit

An optional stones kit can be used with the STPR-MOD-KIT. Install the stones according to the instructions included with the kit.

19. Remove rock stop by removing 1 screw.
20. The IFT control module must be set to 30% turn down. Switch the module to OFF. Locate the turn down selector switch on the top of the control module. Remove the rubber plug. Using a small screwdriver, slide the selector switch to 30. Switch the module back to REMOTE. See Figure 20.

Note: If the turndown percentage is changed while the module is in the ON or REMOTE setting, it will not recognize that the change has occurred. If this happens, the module must be switched to OFF and then back to REMOTE for it to recognize the change.

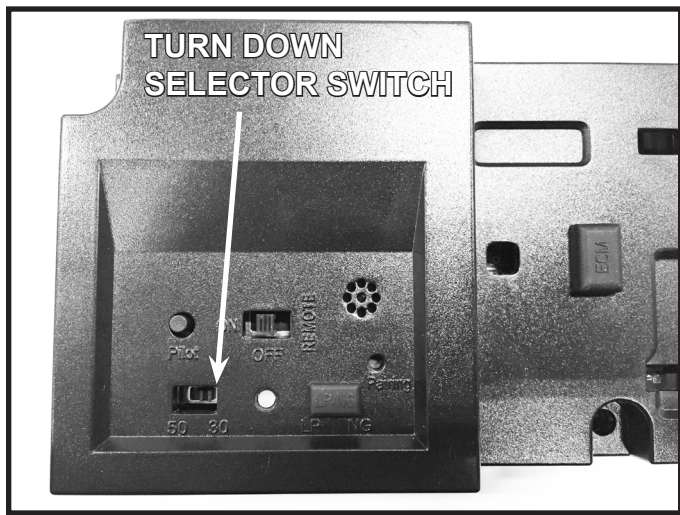

Figure 20. 30% Turndown on Module

21. Adjust shutter as noted in Table 1.

Air Shutter Settings

NG	FULLY CLOSED
PROPANE	FULLY OPEN

Table 1.

Note: A tall, deep orange flame should be avoided; this type of flame may cause increased soot residue. If you notice a tall, deep orange flame, try adjusting the media directly beneath the flame. If all flames appear to be tall and deep orange in color, then open the primary air shutter.

22. Reinstall glass assemblies and decorative fronts.
23. Verify the visual appearance of the flame. The flames will start out blue and gradually turn yellow. The flames must not contact the stones. If they do make contact, shut the unit down and make adjustments as needed.

Propane Models Only: After 45 minutes, the flames should be mostly yellow. If flames remain too blue, adjust the primary shutter accordingly.

Service Parts

DESCRIPTION	PART NUMBER
Pilot Shield Rock Stop Assembly	SRV2488-005
Burner Assembly	SRV2488-008
Pilot Bracket	SRV2488-127
Mesh	2290-107
Stone Placement Jig (Included in MEDIA-STONES-30 kit)	SRV2488-080

Please contact your Hearth & Home Technologies dealer with any questions or concerns.
For the location of your nearest Hearth & Home Technologies dealer, please visit www.hearthnhome.com.

Hearth & Home Technologies
7571 215th Street West, Lakeville, MN 55044
www.hearthnhome.com.